

PLUG MML H2.5-JACK SMA BULKHEAD

R302.255.001 XXX

PANEL SEALED-CABLE 1.33/50S-BR LG=XXXMM

Series : MML

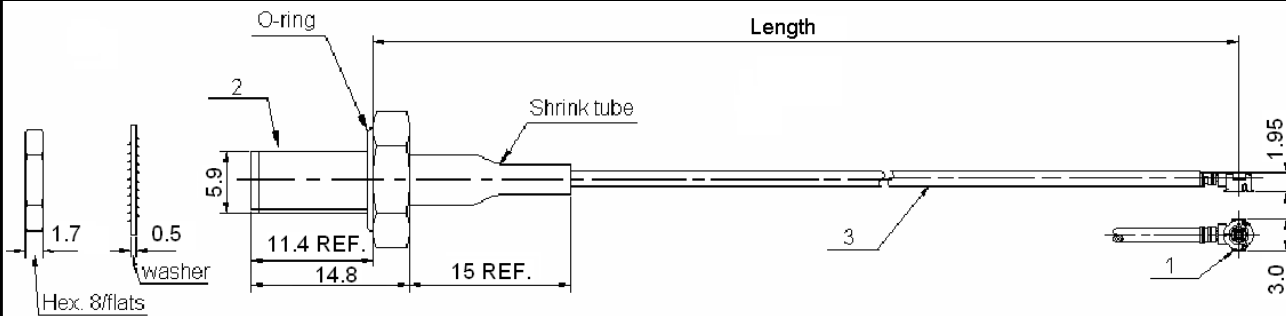

PANEL CUT OUT

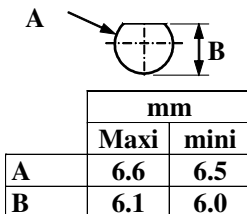

Length=XXX	Step	Tolerance
30 to 100	10	±2
110 to 200		±3
225 to 300	25	±5
325 to 400		±10

E.q. XXX=070 means length is 70±2, the part number is R302.255.001 070

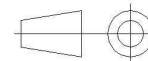

All dimensions are in mm.

- * 1 * Connector A : **MML H2.5 PLUG(gold plated)**
- * 2 * Connector B : **SMA JACK BULKHEAD PANEL SEALED(gold plated)**
- * 3 * Cable : **1.33/50S BLACK**

ELECTRICAL CHARACTERISTICS

Impedance	50 Ω
Frequency	0-6 GHz
Operating temperature	-40~+90 ° C
VSWR	1.3 ** + 0.00 x F(GHz) Maxi
Insertion loss	0.73* √F(GHz) dB Maxi
Voltage rating	250 Veff Maxi
Dielectric withstanding voltage	300 Veff mini
Insulation resistance	500 MΩ mini

SPECIFICATION

Weight	3.00 * g
Cable retention	4 N mini
Mating life	30 cycles
Others : ** VSWR up to 3GHz 1.3 max	
up to 6GHz 1.5 max	

Length	*Insertion loss(Maxi)	*Weight(Maxi)
30 to 100	0.73 dB	3.00 g
110 to 200	1.16 dB	3.60 g
225 to 400	2.02 dB	4.10 g

Mating status

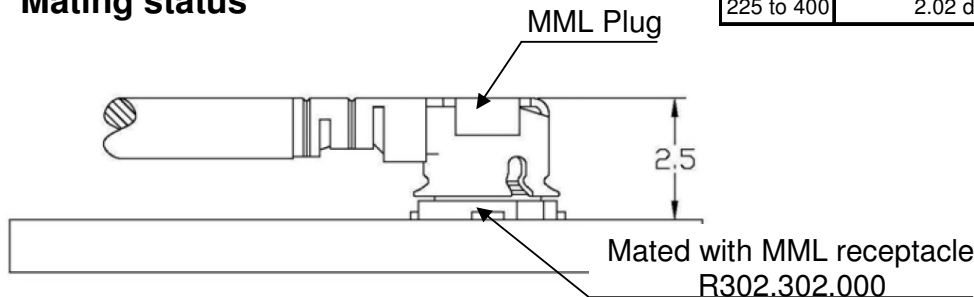

Edition : 1337 A

Design changes may be in order to improve the product.

This document contains proprietary information and such information shall not be disclosed to any third party for any purpose whatsoever or used for manufacturing purposes without prior written agreement from RADIALL

